

SECTION A  
SCALE: 3/8" = 1'-0"

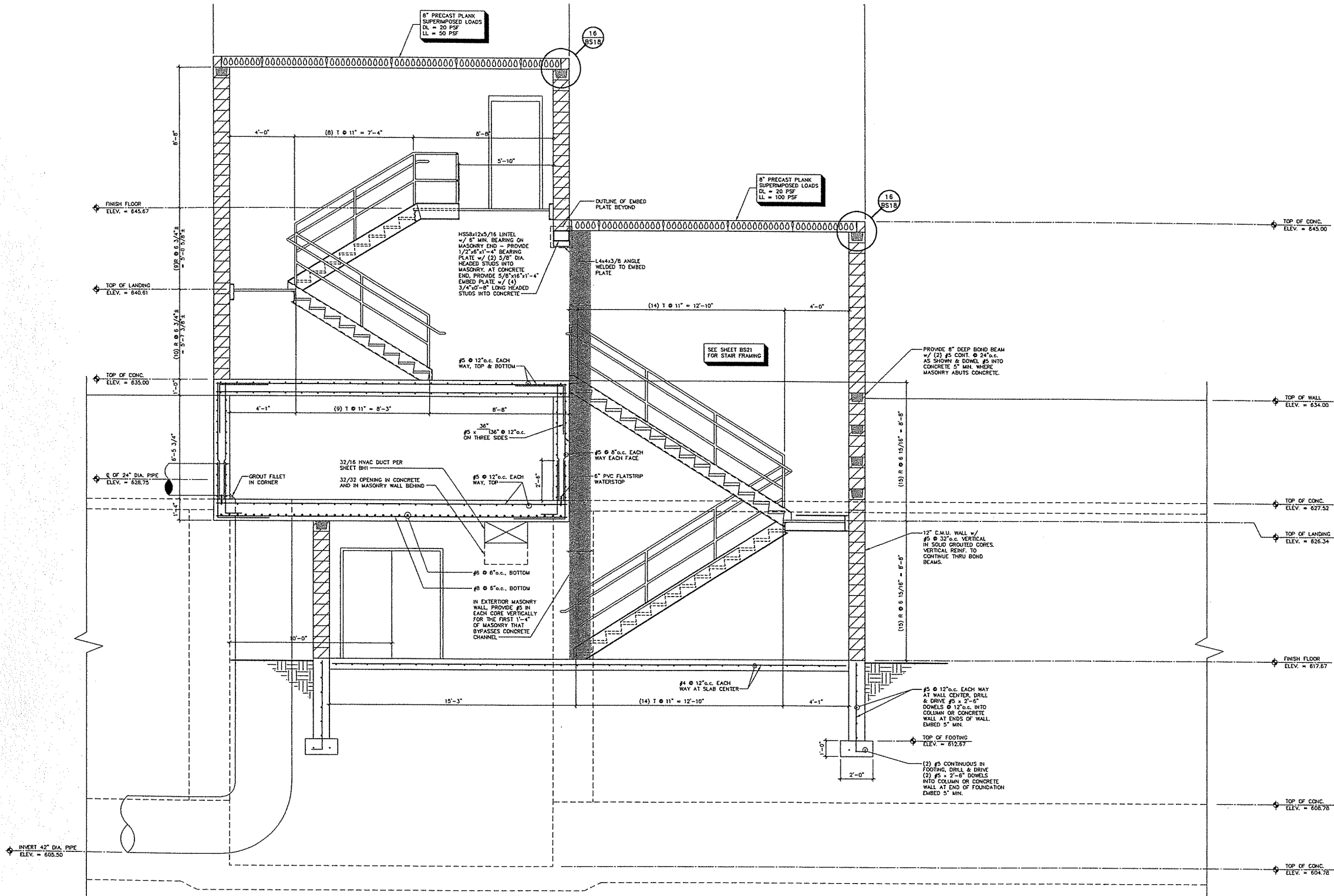



8" PRECAST PLANK  
SUPERIMPOSED LOADS  
DL = 20 PSF  
LL = 50 PSF

8" PRECAST PLANK  
SUPERIMPOSED LOADS  
DL = 20 PSF  
LL = 100 PSF

HSSBx12x5/16 LINTEL  
w/ 8" MIN. BEARING ON  
MASONRY END - PROVIDE  
1/2"x2"x1"x4" BEARING  
PLATE w/ (2) 3/8" DIA.  
HEADED STUDS INTO  
MASONRY. AT CONCRETE  
END, PROVIDE 5/8"x18"x1'-4"  
EMBED PLATE w/ (4)  
3/4"x10"-8" LONG HEADED  
STUDS INTO CONCRETE

SEE SHEET BS21  
FOR STAIR FRAMING

PROVIDE 8" DEEP BOND BEAM  
w/ (3) #5 CONT. @ 24" o.c.  
AS SHOWN & DOWEL #5 INTO  
CONCRETE 5" MIN. WHERE  
MASONRY ABUTS CONCRETE.

32/16 HVAC DUCT PER  
SHEET BS11

IN EXTERIOR MASONRY  
WALL PROVIDE #5 IN  
EACH CORE VERTICALLY  
FOR THE FIRST 1'-4"  
OF MASONRY THAT  
BYPASSES CONCRETE  
CHANNEL

12" C.M.U. WALL w/  
#5 @ 32" o.c. VERTICAL  
IN SOLID GROUTED CORES.  
VERTICAL REINF. TO  
CONTINUE THRU BOND  
BEAMS.

#5 @ 12" o.c. EACH WAY  
AT WALL CENTER. DRILL  
& DRIVE #5 x 2'-6"  
DOWELS @ 12" o.c. INTO  
COLUMN OR CONCRETE  
WALL AT ENDS OF WALL.  
EMBED 5" MIN.

(2) #5 CONTINUOUS IN  
FOOTING. DRILL & DRIVE  
(2) #5 x 2'-6" DOWELS  
INTO COLUMN OR CONCRETE  
WALL AT END OF FOUNDATION.  
EMBED 5" MIN.

**SECTION**  
SCALE: 3/8" = 1'-0"  
LL  
BS16

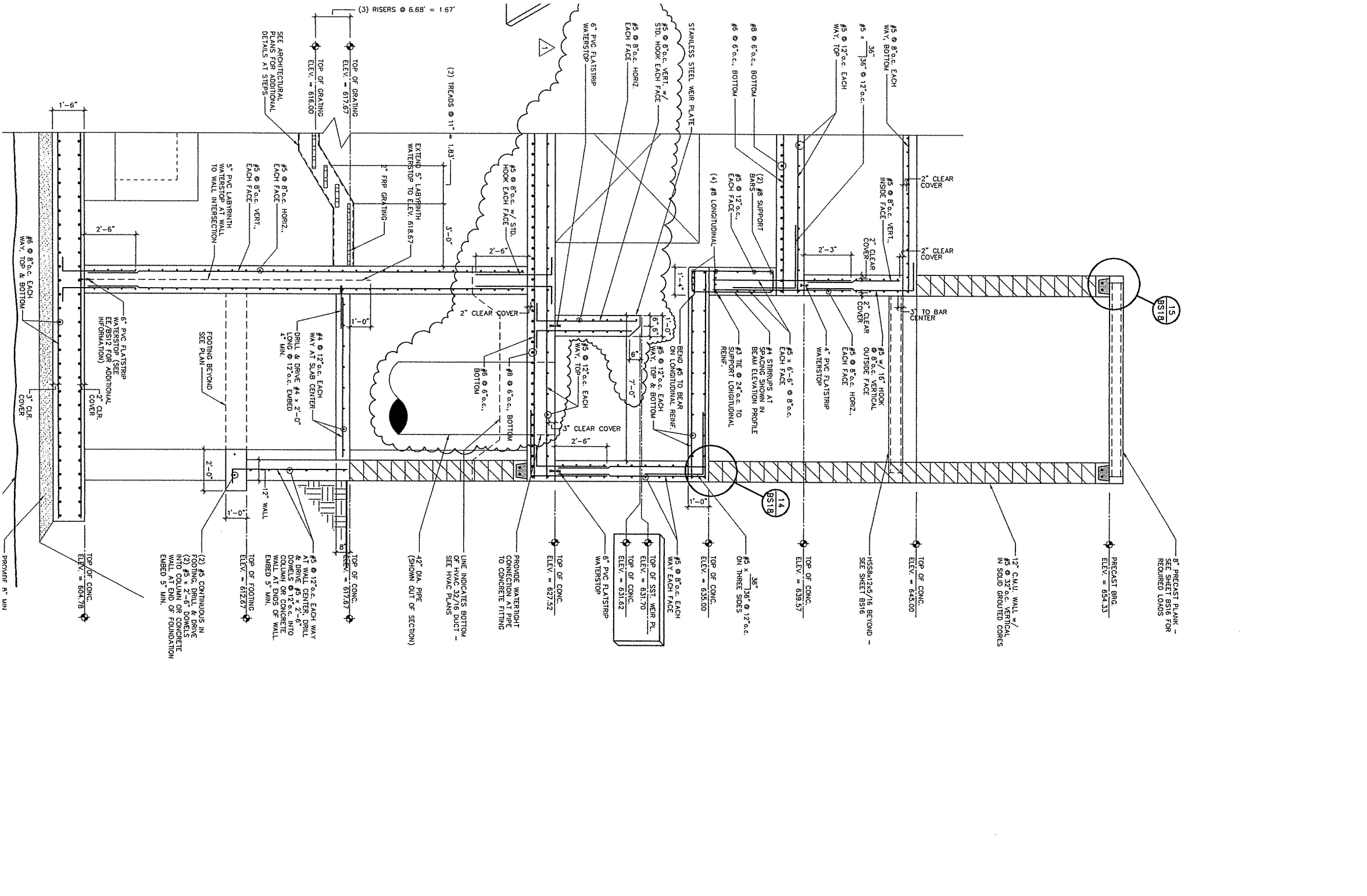

HEART OF THE VALLEY METROPOLITAN SEWERAGE DISTRICT